



Stud Wall System

ExoAir® Trio Impregnated Compressed Tape

1. PURPOSE

1.1 The purpose of this document is to establish guidelines for T3 solution installation of ExoAir® Trio in stud and block wall designs.

1.2 The techniques involved may require modifications to adjust to jobsite conditions. Consult your Tremco representative for specific design requirements.

2. SCOPE

2.1 This documentation will provide the necessary instructions for installation of ExoAir Trio in wood stud, metal stud and concrete block wall designs to qualify for a manufacturer's warranty.

3.0 CONDITIONS FOR SURFACES

3.1 Wood, metal or concrete for the rough opening must be free of loose material and other construction materials.

4.0 DIMENSION GUIDELINE

4.1 ExoAir Trio width must bridge the gap from the edge of the outer frame of the window to the inner piece of glass to eliminate thermal bridge.

4.2 ExoAir Trio thicknesses will be determined by the size range of the gap. The size ranges are as follows:

- 6/32"-12/32" (5-10mm)
- 9/32"-19/32" (7-15mm)
- 12/32"-24/32" (10-20mm)

If the gap exceeds the stated range, a greater thickness must be used or, if the application allows, apply two or more layers of ExoAir Trio on top of one another. Additional dimensions may be provided upon request.

5.0 APPLICATION

5.1 Remove green backing with a utility knife. Retain green backing to rewrap remaining ExoAir Trio to maintain compression prior to installation. With scissors, remove and discard approximately 1" (25mm) of the initial roll of ExoAir Trio (Figure A).

5.2 Install white indicator side to the interior side of the window.

5.3 ExoAir Trio will be installed first in the sill, followed by the jambs and lastly the head of the window.

Install a bead of Spectrem 1 Sealant in corner of the sill and both jambs (Figure B).



(Figure A)

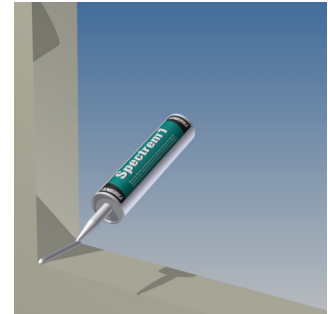

(Figure B)

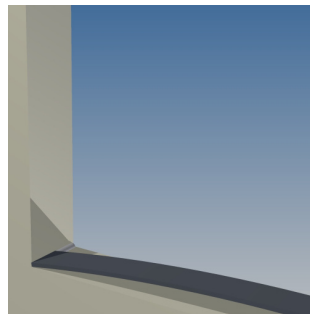

(Figure C)

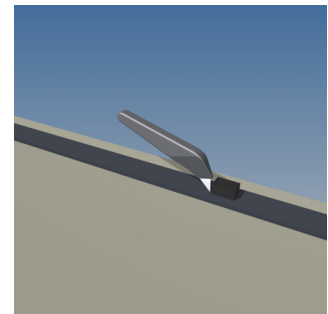

(Figure D)

Cut ExoAir Trio for sill 1-1/2" (38mm) longer than the rough opening. Remove white backing. Apply the ends of the tape into each corner sticking them into the bead of Spectrem 1 and flatten the tape beginning at the center and working towards jambs to ensure the corners are airtight.(Figure C). Do not stretch material when applying.

If setting blocks are required, set blocks to take the load (ASTM 2112-07). Setting blocks and ExoAir Trio should be installed such that the setting block will be completely surrounded by the ExoAir Trio after installation. Cut the center of the ExoAir Trio with a utility knife to fit around the setting blocks and remove the ExoAir Trio. Adhere setting blocks to the rough opening with Spectrem 1 Sealant (Figure D).

Follow the same process for both jambs. Cut ExoAir Trio 1-1/2" (38mm) longer than the jambs. Remove white backing. Apply the ends of the tape into each corner sticking them into the bead of Tremco Spectrem 1 at the sill and flatten the tape beginning at the center and working towards the sill and head to ensure corners are air tight. Do not stretch material when applying.



(Figure E)

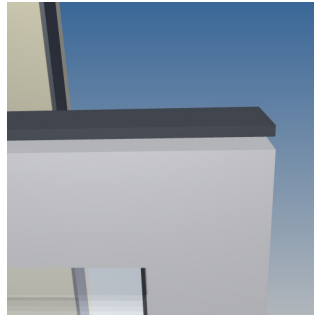

(Figure F)



(Figure I)



(Figure J)



(Figure G)



(Figure H)



(Figure K)

Cut ExoAir Trio for head $\frac{1}{4}$ " (6.4mm) longer than the head of the window profile. Adhere the ExoAir Trio to the window profile head beginning at the center and flattening towards the ends with $\frac{1}{8}$ " (3.2mm) extending past profile edge on each side (Figures E&F).

Insert the window into the opening taking care not to disrupt ExoAir Trio. Use a flat blade putty knife to adjust ExoAir Trio to avoid any disruption. Fold down the $\frac{1}{8}$ " (3.2mm) of ExoAir Trio on the profile head if needed during installation. Once installed, lift up the over lapped ExoAir Trio on the head to allow proper seating of the joint during expansion (Figure H).

Do not install corners by wrapping ExoAir Trio around the window edge.

5.4 When a roll ends, start a new roll in accordance with Section 5.1. Butt roll ends together. Overlap is not required. (Figure G).

5.5 Using proper ShimCon or equal anchors, set jamb and header anchors. Adjust anchors and shim to plumb and level. Anchor the opposite jamb and re-check plumb and square. Adjust as necessary. If shims leave gaps, cut ExoAir Trio along the side of the shim to allow expansion. If shims extend through the ExoAir Trio, the airtight seal will be jeopardized (Figure I). ExoAir Trio is self-gasketing and window may be attached to rough opening by screwing through the ExoAir Trio (Figure J).

5.6 There is no need to caulk/seal the joint between the ExoAir Trio and rough opening. If there is the potential for standing water, please consult your Tremco Representative. ExoAir Trio generally expands to close the gap within 30-45 minutes at 77°F (25°C).

6.0 CLEANUP

6.1 There is little to no cleanup or waste with ExoAir Trio. It is an article and requires no curing.

